

# Don't keep your cells waiting.

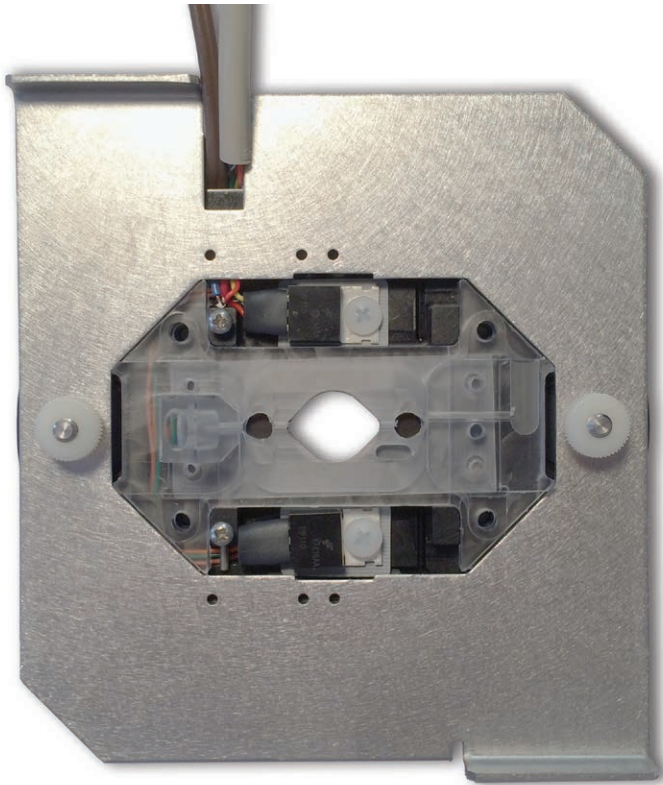

## QuickStage™ microscope stage adapters and heated perfusion chambers

- Integrated spill channel
- Magnetic stainless steel tool platform
- For Nikon, Olympus, Zeiss and Leica upright & inverted microscopes

The AutoMate Scientific QuickStage is designed to fit directly into your Olympus, Nikon, Zeiss (K & M), Leica, Siskiyou, Scientifica, Narishige, Thor Labs, ASI, Prior, Märzhäuser or Sutter microscope stage or platform. With a simple twist of two locking nuts, the entire stainless magnetic Tool Tray lifts off with all of your magnetic tools still attached. The underlying chamber and coverslip are then free for easy cleaning and replacement. Optical #1 thickness cover slips provide a perfect imaging surface for upright or inverted microscopy.

The heated version of the QuickStage uses AutoMate Scientific's popular ThermoClamp temperature controller to maintain your set temperature from ambient to 50°C. Disassembly and cleaning of the heated chamber is just as simple as the unheated version. The ferro-stainless Tool Tray can be removed with all of your tubes and electrodes intact. A silicone gasket ensures leak-free performance without messy grease. Stage heating is maintained while coverslips are replaced so you can begin recording again sooner.

### Assembly View

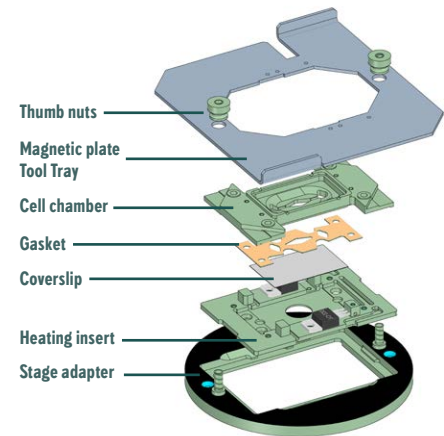

Release two thumb nuts to change coverslips and clean the entire stack, while the magnetic Tool Tray holds your tubes and electrodes for the next experiment. See next page for more photos.

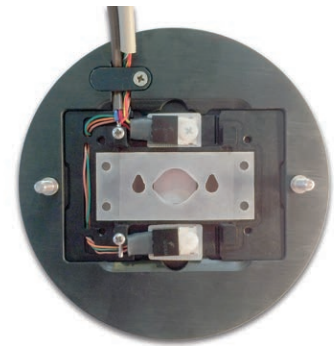

Shown with Tool Tray removed. Gasket and heaters visible with two studs for fast disassembly. Standard 24 x 40 mm coverslip lies under gasket.

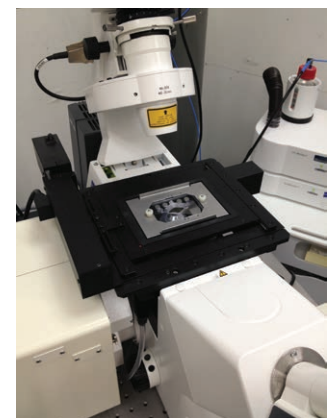

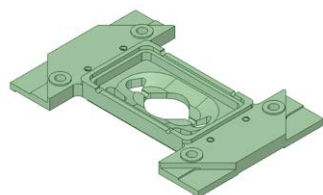

12 mm chamber  
All of these chambers take a 24x40 mm coverslip on the bottom. One included.

## QuickStage Perfusion Chambers

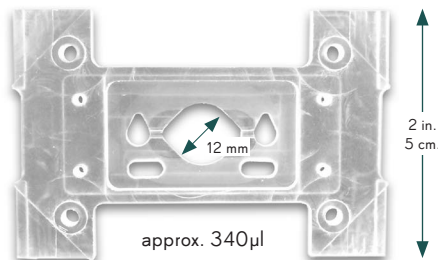

Standard laminar flow chamber for inverted microscopes (QS-H-12IN) also accepts 12 mm round coverslips

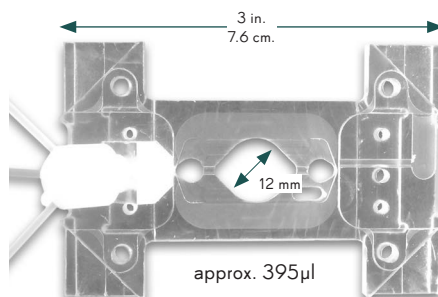

Standard laminar flow chamber for upright microscopes (QS-H-12UP) also accepts 12 mm round coverslips shown with separate inflow manifold

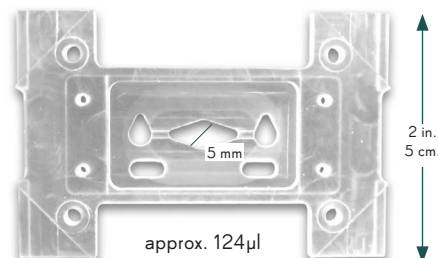

Small laminar flow chamber for inverted microscopes (QS-H-5IN) also accepts 5 mm round coverslips

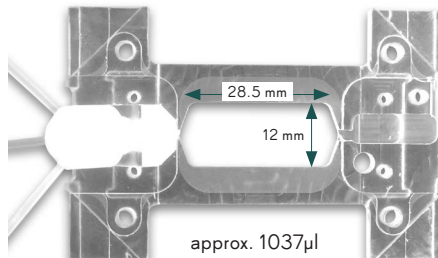

Large bath or slice chamber for upright microscopes (QS-H-LS) shown with separate inflow manifold

## Unheated Perfusion Chambers



Horizontal (H)



Round (R)



Vertical (V)

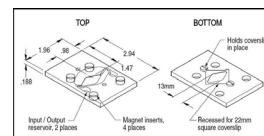
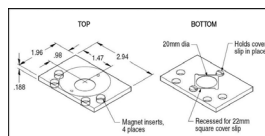
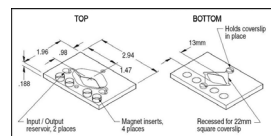

Unheated perfusion chambers: horizontal, round, and vertical (QS-U-H, -V & -R)  
These use 22 mm square #1 coverslips on the bottom, and accept 13 mm round coverslips on top.  
These work with any of the stage adapters to the left.

## 35mm Petri Dish Holders and Heaters

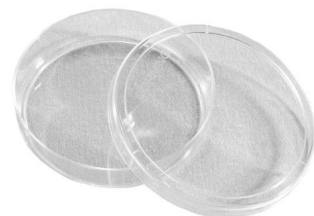

Adapters for Nunc, WillCo, Falcon, In Vitro (D35-10-1-N), Corning, Mattek, and In Vitro (D29-10-1-N) 35mm dishes available.

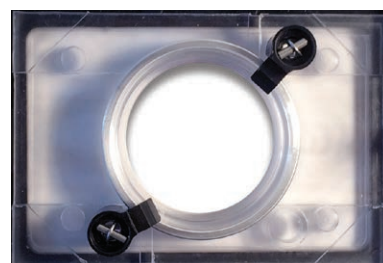

Unheated 35mm Petri dish holder (QS-U-35) with spring clips and Nunc adapter ring  
This adapter also holds full-size slides

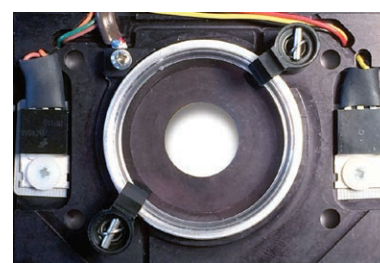

Heated 35mm Petri dish holder (QS-H-35) with spring clips and Corning adapter ring



See chart on the next three pages to select the appropriate stage adapter for your microscope and stage.

Tool Trays are ferro-magnetic stainless steel plates designed to hold your perfusion chamber down to the stage adapter while also providing a large surface for StageHands™ magnetic tool holders. Round stage adapters (i.e. Olympus and Nikon) include a square Tool Tray (4.25 in / 10.8 cm wide x 4.56 / 11.6 cm deep). Rectangular stage adapters (i.e. Zeiss and Universal) include a rectangular Tool Tray (5 in. / 12.7 cm x 3.5 in / 8.9 cm deep).

If you don't have room on your stage for a Tool Tray, or think it is too large, you can order your QuickStage with Clamps instead. They hold the perfusion chamber down to the stage adapter using the same two thumb nuts on each side. For heated cell chambers (not unheated chambers or 35 mm dish holders), Clamps also require four small screws to hold the chamber, gasket and coverslip to the heating adapter.

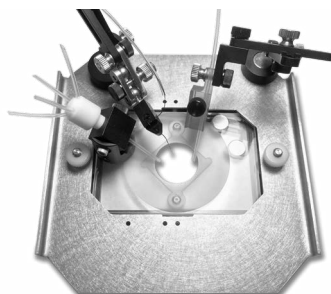

QS-U-R-TT-O  
Round unheated chamber in  
Olympus round stage adapter and  
square Tool tray with StageHands.

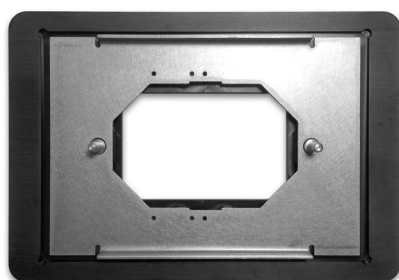

Zeiss K stage adapter showing rectangular Tool Tray with thumb screws removed.

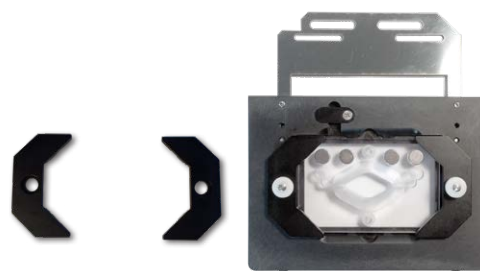

Clamps (left) installed on a universal stage adapter (right) holding an unheated horizontal chamber.

Microscope	Configuration	Model	Stage Type	Detachable (Single Plate) or Non (3 Plate)	AutoMate Stage Adapter
ZEISS	Inverted	Axiovert 100	Mechanical	Detachable Object Guide	ZM = Zeiss M
		Axiovert 135			
				Non Detachable	ZK = Zeiss K
		Axiovert 200	Mechanical	Detachable Object Guide	ZM = Zeiss M
		LSM META Confocal			
				Non Detachable	ZK = Zeiss K
			Electronic	Non Detachable	ZK = Zeiss K
		Axio Observer	Mechanical	Non Detachable	ZK = Zeiss K
			Electronic	Non Detachable	
		Axiovert 100	Märzhäuser	Scan IM 130X100	ZK = Zeiss K
		Axiovert 135			
		Axiovert 200			
		Axio Observer			
	Upright	Axioskop 2 FS	Mechanical	Non Detachable	UU = Universal
		Axioskop FS			
		LSM META FS MOT			
		Axio Examiner		Non Detachable	UU = Universal
		LSM 710 NLO			
				Various Options	Please email
OLYMPUS	Inverted	IX50	Mechanical	Non Detachable	O = Olympus Ring
		IX70			
		IX51		Detachable	UU = Universal
		IX71			
		IX81			
			Electronic	Märzhäuser IM 120X80	ZK = Zeiss K
		IX51			
		IX71			
		IX81			
			Olympus Bridge Stage	WI XYZ Stage Fixed	O = Olympus Ring
		BX FS WI			
				Microscope Mover	
				Fixed Stage	Narishige
				Microscope Translator	ThorLabs
			Mechanical	Non Detachable	
		BX FS WI	Mechanical	Non Detachable	UU = Universal
		BX Stage Focus			
		BX51 TF, TRF			
		BX61 TF, TRF			
			ThorLabs		
		BX FS WI		Avt Mounted Stand	O = Olympus Ring

Electronic Stages: if the insert cannot be definitively identified, the customer should test that the stage adapter does not interfere with stage components during motion.



Microscope	Configuration	Model	Stage Type	Detachable (Single Plate) or Non (3 Plate)	AutoMate Stage Adapter	
NIKON	Inverted	Diaphot TMD	Mechanical	Non Detachable	N = Nikon Ring	
		TMS				
		Diaphot 200				
		Diaphot 300				
		TE200				
		TE300				
		Ti				
	Orange rows = not available		Ti	Mechanical	Detachable	N/A
			Ti-S-E	Nikon Motorized	Non Detachable	N=Nikon Ring
Ti-S-ER						
Ti-S-E			ASI Flat Top & Piezo	Non Detachable	ZK = Zeiss K	
Ti-S-ER						
		TE200	Electronic	Māzh Scan IM Stages	ZK = Zeiss K	
		TE300				
Upright		FN1		Mechanical	Non Detachable	FN1 = Nikon Ring
				Nikon	Nikon Stage	
				ThorLabs	Thorlabs MPM-XYRS	
		FN1		Fixed	Static	O = Olympus Ring
			Narishige	ITS-N		
			ThorLabs	PHYS24		
Inverted	TS100	Mechanical	Detachable	UU = Universal		
LEICA	Inverted	DMI 3000-6000	Mechanical	Attachable To Micromanipulator	Holding Frame N/A	
		DMIRB		Slim Fixed Stage		
		DMI 3000-6000	Mechanical	Non Detachable	ZK = Zeiss K	
				Non Detachable	ZP = Zeiss Plane	
				Non Detachable Slim	88 mm Ring N/A	
		DMI 3000-6000	Electronic	Motorized 3 Plate	ZK = Zeiss K	
				Motorized 3 Plate	ZP = Zeiss Plane	
				Slim Motorized 3 Plate	88 mm Ring N/A	
				Leica Scanning 127X83	ZK = Zeiss K	
				Prior Pro Scan	ZK = Zeiss K	
				ITK LMT200	ZK = Zeiss K	
		DMI 3000-6000	Electronic	Māzh Scan IM 130X85	ZK = Zeiss K	
		DMIRB				
		DMIL				
		DMI 3000-6000	Mechanical	Detachable Object Guide	ZM = Zeiss M	
		DMIRB				
DMIL						
DMIRB	Mechanical	Non Detachable	Square Adapter N/A			
DMIL						



Microscope	Configuration	Model	Stage Type	Detachable (Single Plate) or Non (3 Plate)	AutoMate Stage Adapter
LEICA	Upright	DM6000 FS	Mechanical	Non Detachable	UU = Universal
		DM6000 B	Electronic	Non Detachable	
		DM5500 B			
		DM6000 B	Mechanical	Non Detachable	
		DM5000 B			
		DM4000 B			
NARISHIGE	Upright Olympus	E600FN	Microscope Translator	Narishige ITS-N	O = Olympus Ring
		BX50WI		Narishige ITS-O	
		BX51WI		Narishige ITS-O2	
		BX61WI		Narishige ITS-O2	
	Zeiss	Axioskop FS		Narishige ITS-Z	
		Axioskop 2FS		Narishige ITS-Z2	
		Axio Examiner		Narishige ITS-Z3	
	Leica	DMLFS		Narishige ITS-L	
THORLABS	Upright Olympus	Gibraltar	Microscope Translator	Gibraltar	O = Olympus Ring
		BX50WI		BX Series	
		IX70		IX70	
	Zeiss	Axioskop FS		FS Series	
		Axioskop 2 FS		FS Series	
	Leica	DMLFS		LFS Series	
SUTTER		MT-150/Trapini Tower	MT-1000		N = Nikon Ring
		MT-78, MP-78	MT-78		ZK = Zeiss K
SISKIYOU		8090P	8090P		N = Nikon Ring

Electronic Stages: if the insert cannot be definitively identified, the customer should test that the stage adapter does not interfere with stage components during motion.

## Dual-channel ThermoClamp®-2 Temperature Controller



Two independent channels for simultaneous heating of Environmental Lid or Perfusion Pencil® inline heater and heated QuickStage.

## Heated Environmental Lid for 35mm dishes



Heated glass lid with perfusion and gas control attaches magnetically to the top of our 35mm dish holders. Control the temperature of a large 30 mm coverslip lid to minimize condensation while maintaining gas and temperature control over your 35mm dish. Separate perfusion inflow, aspiration outflow, gas connection, temperature sensor and grounding provided.

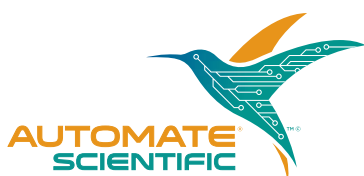

## QuickStage™ Part Numbers

QS- (H)eated	–	Perfusion Chamber:	–	Retainer:	–	Microscope Stage Adapter:
CELL CHAMBER : HEATING INSERT with ThermoClamp controller		<b>12IN</b> =12 mm diamond / round coverslip (inverted) <b>5IN</b> =5 mm diamond / round coverslip (inverted) <b>12UP</b> =12 mm diamond / round coverslip (upright) <b>LS</b> =large slice chamber (upright) The four above use 24x40 mm rectangular #1 coverslips bases (one included) <i>35 mm Petri dish heaters:</i>		<b>TT</b> =Tool tray <b>C</b> =Clip		<b>ZM</b> =Zeiss/Leica M <b>ZK</b> =Zeiss/Leica K / ASI / Prior / März Sutter MT/MP-78 <b>ZP</b> =Zeiss/Leica plane <b>O</b> =Olympus/Narishige/Gibraltar/ Scientifica/ThorLabs 110mm ring <b>N</b> =Nikon/Siskiyou/Sutter MT-150, MT-1000 108mm ring <b>FN1</b> =Nikon FN1 <b>UU</b> =Universal adapter
35 mm DISH : HEATING INSERT with ThermoClamp controller		<b>35N</b> =35 mm Nunc <b>35W</b> =35 mm WillCo <b>35F</b> =35 mm Falcon / In Vitro (D35-10-1-N) <b>35C</b> =35 mm Corning / Mattek <b>35V</b> =35 mm In Vitro (D29-10-1-N)	<b>Spacer rings each:</b>	<b>TT</b> =Tool tray <b>C</b> =Clamp		
QS- (U)nheated	–	Perfusion Chamber:	–	Retainer:	–	Microscope Stage Adapter:
CELL CHAMBERS UNHEATED		<b>H</b> =horizontal diamond <b>V</b> =vertical diamond <b>R</b> =round The three above use 22 mm square bases, and accept 13 mm round #1 coverslips on top <i>35 mm Petri dish holders:</i>		<b>TT</b> =Tool tray <b>C</b> =Clamp		<b>ZM</b> (Same choices as above) <b>ZK</b> <b>ZP</b> <b>UU</b> <b>O</b> <b>N</b> <b>FN1</b>
35 mm DISH HOLDER UNHEATED		<b>35N</b> =35 mm Nunc <b>35W</b> =35 mm WillCo <b>35F</b> =35 mm Falcon / In Vitro (D35-10-1-N) <b>35C</b> =35 mm Corning / Mattek <b>35V</b> =35 mm In Vitro (D29-10-1-N)	<b>Spacer rings each:</b>			<b>Tell us your:</b> • Microscope brand and model • Inverted/upright (i.e. Zeiss Axiovert inverted) • Stage: fixed, adjustable, mechanical, or third party like Narishige or Sutter • Or ask us for a complete list of compatible microscopes.

### Example part numbers:

QS-H-12IN-TT-ZM = QuickStage - Heated - 12mm diamond chamber - Tool tray - Zeiss M stage adapter

QS-U-35W-C-UU = QuickStage - Unheated - 35mm Willco dish holder - Clamp - Universal stage adapter

### Ordering Information (sample combinations shown)

Part No.	QuickStage
	<b>Heated:</b>
QS-H-12IN-TT-ZM	QuickStage Heated diamond 12mm perfusion chamber for Zeiss or Leica M inverted microscope with Tool Tray, gasket and ThermoClamp®-1 temperature controller
QS-H-35W-C-UU	QuickStage Heated 35mm WillCo perfusion chamber with clamp, Universal stage adapter and ThermoClamp-1 temperature controller
	3 add'l chambers + many 35mm dishes & stage adapters available
QS-CS2440	Replacement 24x40 mm #1 coverslips (box of approx. 75 pcs.)
QS-35(N-V)	Additional 35mm adapter rings
QS-GSK- xxx	Replacement Gasket - specify chamber (pack of 5)
	<b>Unheated:</b>
QS-U-H-TT-N	QuickStage Unheated horizontal perfusion chamber and stage adapter for Nikon microscope and Siskiyou platforms
QS-U-35N-TT-O	QuickStage Unheated 35mm Nunc holder, Tool Tray, and stage adapter for Olympus et al. microscope stages
	3 add'l chambers + many 35mm dishes & stage adapters available
	<b>Heated Environmental Lid for 35mm dishes:</b>
QS-HLID	with ThermoClamp-1 controller and bath sensor
QS-H2LID	with ThermoClamp-2 controller and bath sensor (replacing the ThermoClamp-1 included with any heated QuickStage chamber)

### ThermoClamp-1 Controller



Included with all heated chambers.  
Two-channel controller available.

U.S./Canada prices shown. International prices add 15%. Email or visit web store for latest prices.